

PuddlepalTM SS/316

Submersible De-watering Pump

Constructed from 316 Stainless Steel

T-T PUMPS[®]



A versatile, portable, submersible, residue pump for clean water. The pump features the ability to pump down to 1mm, therefore ideal for removing water from flat surfaces such as floors and flat-roofs.

Features

- The 316 Puddlepal is a complete stainless steel unit
- Compact, lightweight design
- Urethane impeller
- Auto-reset thermal protector
- Double mechanical seal
- 6mm solids handling
- 0.4 - 0.75kW output
- 50mm discharge

Applications

- Salt water applications
- Small water features
- Residue
- Cellars and basements
- Nuisance water
- Civil construction
- Quarries and mining
- Hire fleets
- Emergencies
- De-watering
- Lift Shafts

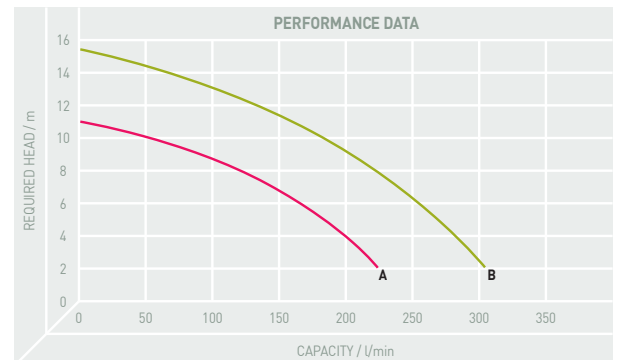

PUMP TYPE	PRODUCT CODE	OUTLET "/ mm	CURVE	kW	FREE PASSAGE mm	WEIGHT kg	CABLE LENGTH m
PAL400 230V	PH/PAL400/SS/316	2"/50mm	A	0.4	6	17	10
PAL750 230V	PH/PAL750/SS/316	2"/50mm	B	0.75	6	19	10

Puddlepal[™] SS/316

Submersible De-watering Pump

Constructed from 316 Stainless Steel

T-T PUMPS[®]

PUDDLEPAL[®] 400/750 PARTS

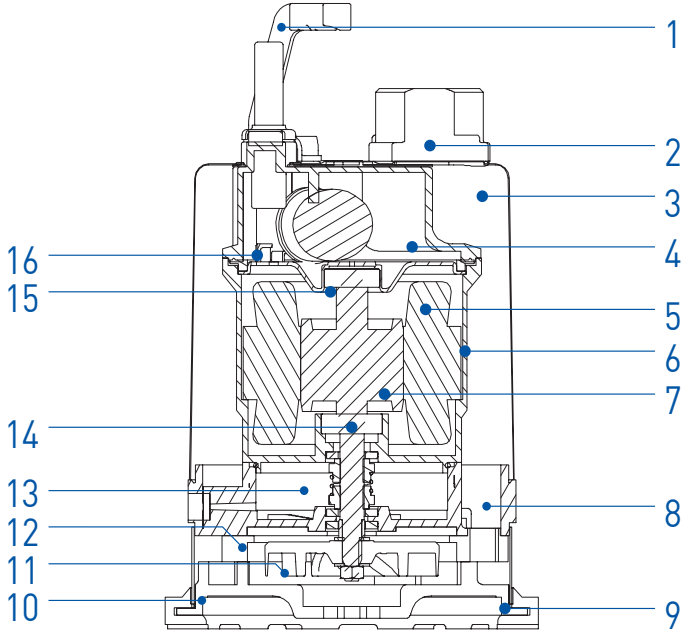

PARTS & MATERIAL LIST		
NUMBER	PART	MATERIAL
1	HANDLE	SS316
2	MOTOR HEAD COVER	SS316
3	OUTER COVER	SS316
4	CAPACITOR	
5	STATOR	
6	MOTOR HOUSING	SS316
7	SHAFT & ROTAR	SUS410
8	SEAL CASING	SS316
9	STRAINER	SS316
10	PUMP HOUSING	SS316
11	IMPELLER	SS316
12	PACKING	NBR
13	MECHANICAL SEAL	SIC/SIC
14	LOWER BEARING	
15	UPPER BEARING	
16	MOTOR BRACKET	SS316

